

MODEL
FSCDXAN-W2H

Flow divider valve
CAPACITY: 6 - 30 L/min. | **CAVITY:** T-31A

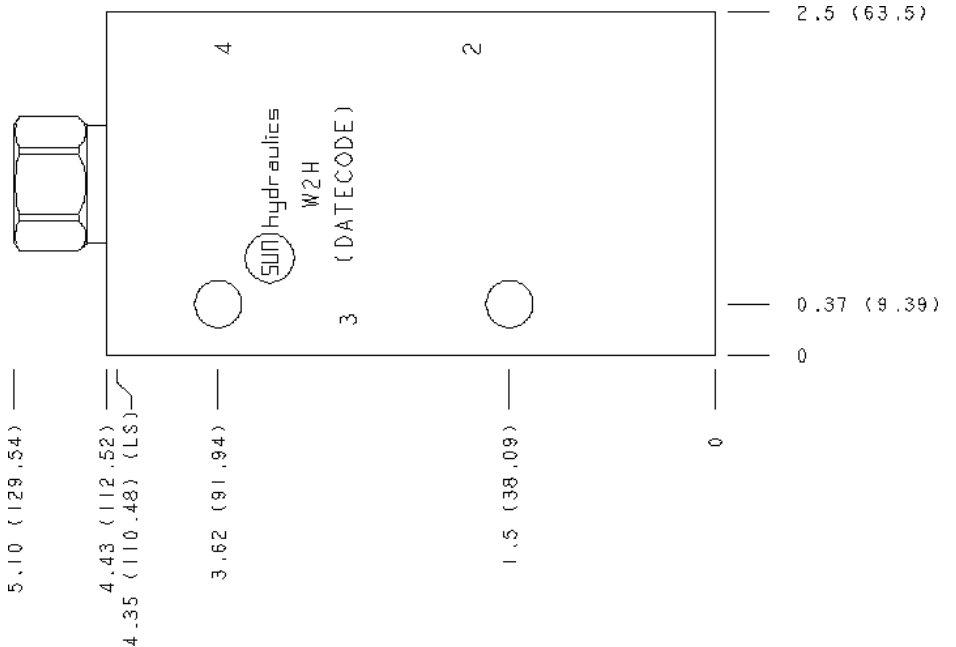
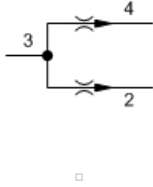

CARTRIDGE CONFIGURATION

X	Control	Not Adjustable
A	Flow Split	50/50
N	Seal Material	Buna-N
(none)	Material/Coating	Standard Material/Coating

MANIFOLD CONFIGURATION

(none)	Modifier	6061-T651 Aluminum, Buna-N
---------------	----------	----------------------------

PORT HEADINGS AND SIZES

Modifiers	Ports
W2H	All Ports: 3/8" BSPP;

NOTES

Important: Carefully consider the maximum system pressure. The pressure rating of the manifold is dependent on the manifold material, with the port type/size a secondary consideration. Manifolds constructed of aluminum are not rated for pressures higher than 3000 psi (210 bar), regardless of the port type/size specified.

Flow dividers are sliding-spool, pressure-compensated devices used to split oil flow to two different branches of a circuit in a designated ratio. These valves are suitable for applications that use the following: unidirectional hydraulic motors, hydraulic cylinders where flow division in one direction only is required, and multiple circuits that are serviced from one pump supply.

CARTRIDGE TECHNICAL DATA

Cavity	T-31A
Series	1
Capacity	6 - 30 L/min.
Maximum Operating Pressure	350 bar
Divisional Accuracy at Minimum Input Flow	±6.5%
Divisional Accuracy at Max Input Flow	±3.5%
Pressure Drop at Minimum Rated Input Flow	2 bar
Pressure Drop at Maximum Rated Input Flow	18 bar
Rated Input Flow with 50/50 Split	6 - 30 L/min.
Rated Input Flow with 40/60 Split	5,3 - 26,5 L/min.
Rated Input Flow with 33/67 Split	4,5 - 22,7 L/min.
Valve Hex Size	22,2 mm
Valve Installation Torque	41 - 47 Nm
Seal kit - Cartridge	Buna: 990-031-007
Seal kit - Cartridge	Polyurethane: 990-031-002
Seal kit - Cartridge	Viton: 990-031-006
Model Weight	0.00 kg.

MANIFOLD TECHNICAL DATA

Body Type	Hex manifold
-----------	--------------

Body Type	Line mount
Interface	None
Body Features	Ninety degree
Mounting Hole Diameter	8.6 mm
Mounting Hole Depth	Through
Mounting Hole Quantity	2
Open Cavities	1
Cavity	T-31A
Port Size	3/8" BSPP
Model Weight	0.50 kg.

Copyright © 2002-2017 Sun Hydraulics Corporation. All rights reserved.